

ALCOA HIGHWAY LANDSCAPE PLAN
KNOXVILLE, TN
ALCOA HIGHWAY BEAUTIFICATION COUNCIL

PRELIMINARY
NOT FOR
CONSTRUCTION

REVISIONS

COPYRIGHT © ROSS/FOWLER, P.C. 2020
PROJECT NUMBER: 19017
ISSUE DATE: 07.03.2020

ENLARGED
SOILS PLAN

L201

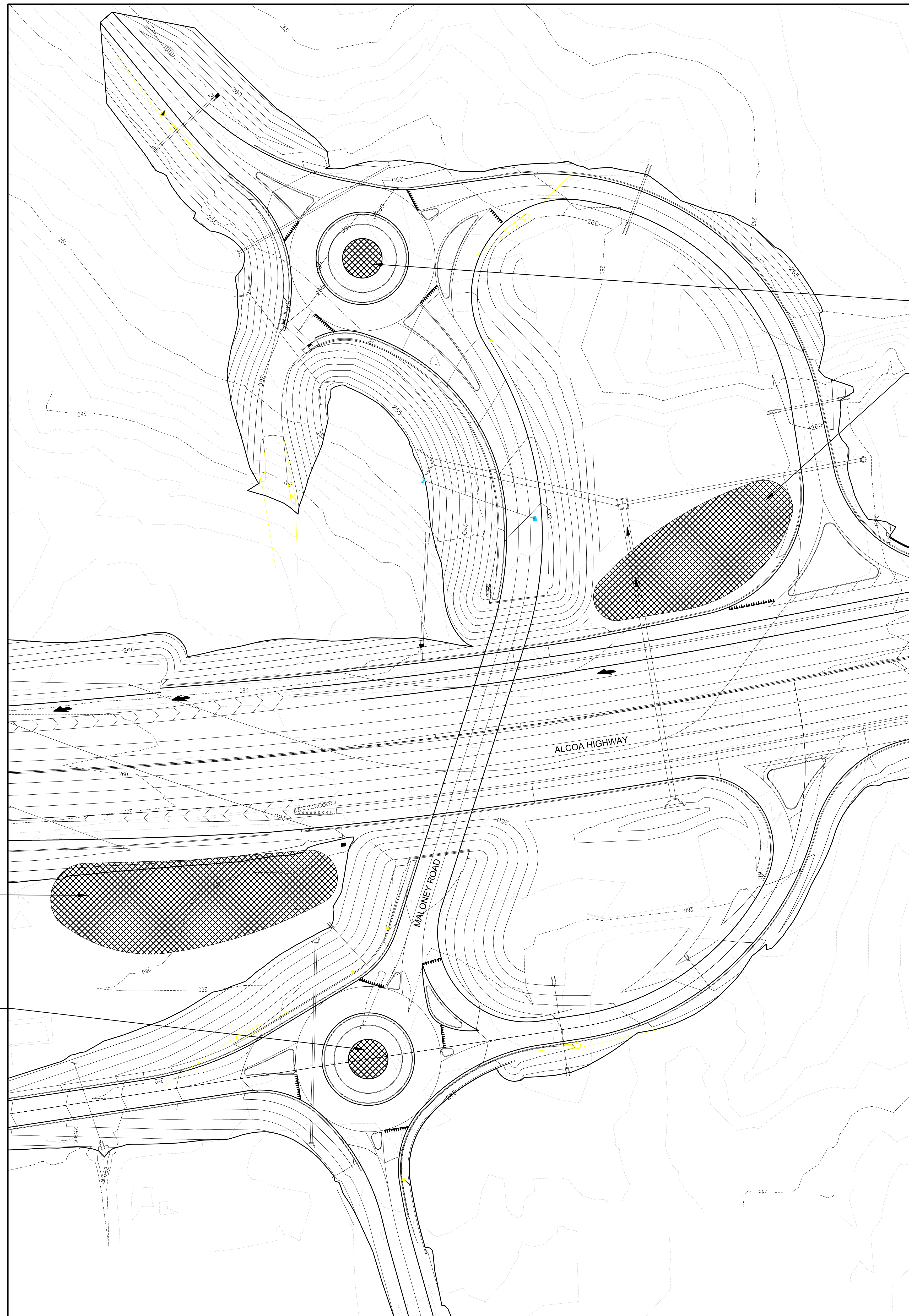

1 MALONEY ROAD
L201 SCALE: 1"=50'

0 50 100 150

PRIORITY AREA #1
MONTLAKE DRIVE ROUNDABOUT
REPLACE SOIL WITH TOPSOIL TO 18"
DEPTH, APPROX. 67 CUBIC YARDS

PRIORITY AREA #1
MALONEY ROAD WEST ROUNDABOUT
REPLACE SOIL WITH TOPSOIL TO 18"
DEPTH, APPROX. 67 CUBIC YARDS

PRIORITY AREA #2
WILDFLOWER AREA
REPLACE SOIL WITH TOPSOIL TO 8"
DEPTH, APPROX. 384 CUBIC YARDS.
REFER TO WILDFLOWER SOIL PREP
NOTES ON THIS SHEET FOR
ADDITIONAL TREATMENT OF THIS
AREA.

PRIORITY AREA #2
WILDFLOWER AREA
REPLACE SOIL WITH TOPSOIL TO 8"
DEPTH, APPROX. 528 CUBIC YARDS.
REFER TO WILDFLOWER SOIL PREP
NOTES ON THIS SHEET FOR
ADDITIONAL TREATMENT OF THIS
AREA.

PRIORITY AREA #1
MALONEY ROAD EAST ROUNDABOUT
REPLACE SOIL WITH TOPSOIL TO 18"
DEPTH, APPROX. 67 CUBIC YARDS

TOPSOIL NOTES:

1. SOIL DEPTH – TOPSOIL SHALL BE INSTALLED IN 10 TO 12 INCH LIFTS, AND SOIL SHOULD BE STRATIFIED BETWEEN EACH LIFT.
2. SOIL TEXTURE – TOPSOIL SHALL HAVE A CONSISTENT SOIL TEXTURE AND RANGE FROM A LOAM TO SANDY LOAM (85% TO 90%) IN TEXTURE. LARGE CLAY CLOUDS GREATER THAN 1 INCH IN LENGTH SHOULD NOT MAKE UP OVER 10% OF THE SOIL VOLUME AND LARGE CLOUDS OVER 5 INCHES SHOULD BE AVOIDED. DO NOT SCREEN THE SOIL TO ALLOW FOR AERATION WITHIN THE SOIL.
3. SOIL DEBRIS AND CONTAMINANTS – TOPSOIL SHALL BE FREE OF HEAVY METALS, TOXINS, AND DEBRIS INCLUDING BRICK, CONCRETE, WOOD, GLASS, METAL, STONES, AND PLASTIC. NEVER SHALL AN AREA DESIGNATED FOR TREE PLANTING BE USED AS A WASHOUT AREA FOR CONCRETE OR OTHER CONSTRUCTION MATERIAL. UNLESS APPROVED BY THE LANDSCAPE ARCHITECT OR URBAN FORESTER, NO STONES, ROCKS, AND GRAVEL SHALL EXCEED 5% OF THE SOIL VOLUME AND BE LARGER THAN 1 INCH. THE USE OF LIMESTONE IS STRICTLY PROHIBITED WITHOUT THE APPROVAL OF THE LANDSCAPE ARCHITECT OR URBAN FORESTER.
4. ORGANIC MATTER – THE TOPSOIL SHALL HAVE 5% ORGANIC MATTER BY WEIGHT. COMPOST, WOOD CHIPS, AND PINE BARK WITH A pH LESS THAN 7 MAY BE USED TO INCREASE ORGANIC MATTER.
5. SOIL DENSITY – TOPSOIL DENSITY SHALL BE COMPACTED 78%–85%. SOIL SHOULD BE COMPACTED IN 12 INCH LIFTS BASED ON APPLICATION.
6. DRAINAGE – WATER SHOULD BE READILY DRAINED FROM THE TOPSOIL. THE USE OF DRAINAGE PIPES SHOULD BE USED IF PERCOLATION TESTS SHOW DRAINAGE RATES LESS THAN 1 INCH PER HOUR. TARGET PERCOLATION RATE IS 1 TO 3 INCHES PER HOUR.
7. SOIL pH – THE pH OF THE TOPSOIL SHALL BE BETWEEN 6.0 AND 7.0.
8. AFTER TOPSOIL HAS BEEN PLACED, TEST AREAS TO RECEIVE PLANTING FOR THE FOLLOWING ANALYSIS: pH FACTOR, MECHANICAL ANALYSIS, PERCENTAGE OF ORGANIC CONTENT, RECOMMENDATIONS ON TYPE AND QUANTITY OF ADDITIVES REQUIRED TO ESTABLISH SATISFACTORY pH FACTOR AND SUPPLY OF NUTRIENTS TO SATISFACTORY LEVEL FOR PLANTING.

WILDFLOWER AREA SOIL PREPARATION NOTES:

1. REMOVE ALL EXISTING VEGETATION IN AREAS TO BE PLANTED.
2. CULTIVATE THE AREAS TO BE PLANTED TO LOOSEN THE SOIL TO A DEPTH OF 4".
3. REMOVE ANY STONES OVER 1" IN ANY DIMENSION AND STICKS, ROOTS, RUBBISH AND EXTRANEOUS MATTER.
4. GRADE SEEDING AREAS TO A SMOOTH, FREE-DRAINING AND EVEN SURFACE WITH A LOOSE, MODERATELY COARSE TEXTURE. ROLL AND RAKE, REMOVE RIDGES, AND FILL DEPRESSIONS AS REQUIRED TO DRAIN.
5. APPLY LIMESTONE, AT RATE DETERMINED BY THE SOIL TEST, TO ADJUST pH OF PLANTING SOIL. DISTRIBUTE EVENLY BY MACHINE AND INCORPORATE THOROUGHLY INTO PLANTING SOIL.
6. APPLY FERTILIZERS AT RATE DETERMINED BY THE SOIL TEST, AND INCORPORATE THOROUGHLY AND EVENLY INTO PLANTING SOIL TO DEPTH OF 3".
7. APPLY PRE-EMERGENT HERBICIDE IN ALL AREAS RECEIVING WILDFLOWER SEED TO MANAGE WEEDS IN WILDFLOWER BEDS.

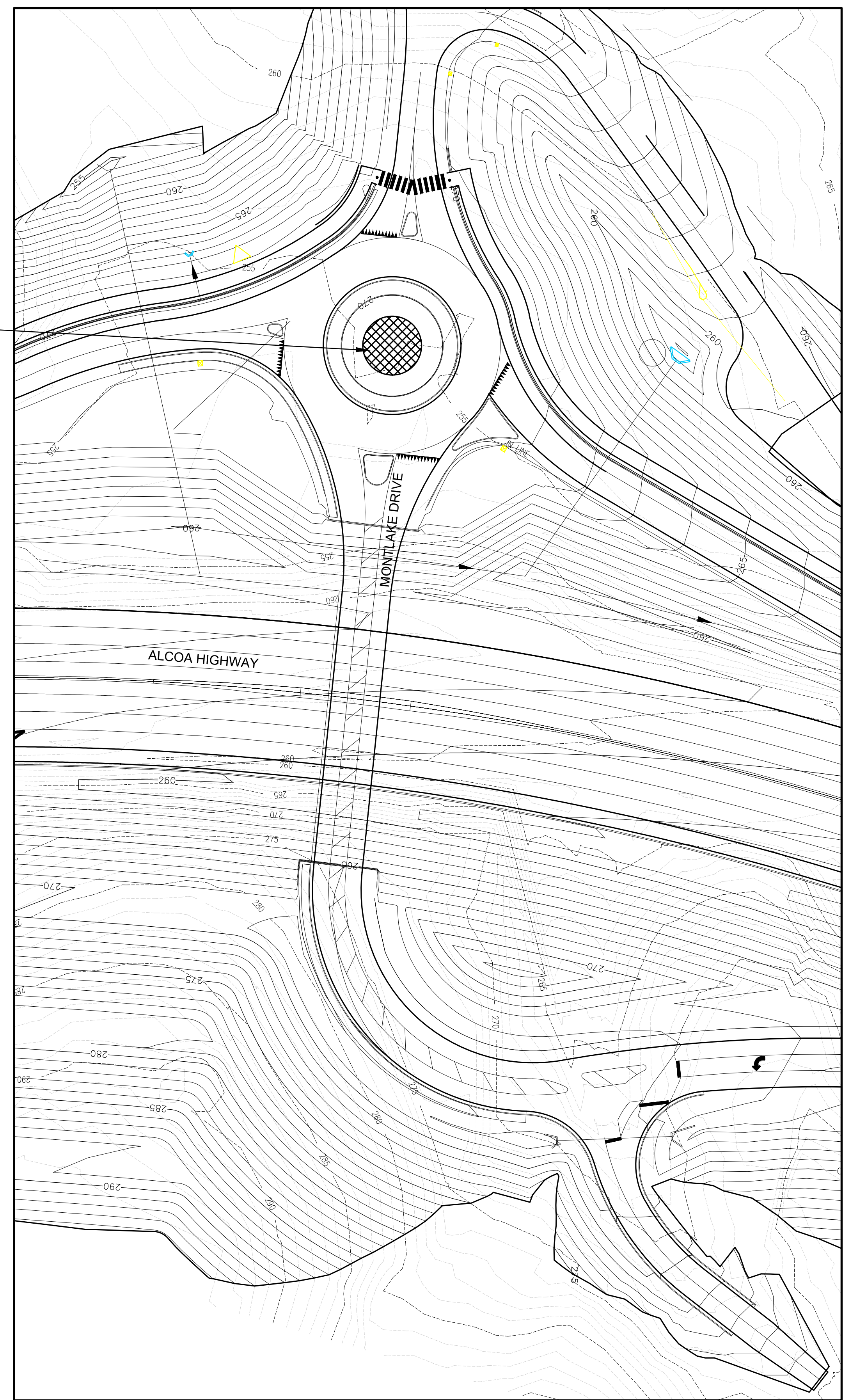

2 MONTLAKE DRIVE
L201 SCALE: 1"=50'

0 50 100 150