

ALCOA HIGHWAY LANDSCAPE PLAN  
KNOXVILLE, TN  
ALCOA HIGHWAY BEAUTIFICATION COUNCIL

PRELIMINARY  
NOT FOR  
CONSTRUCTION

REVISIONS

COPYRIGHT © ROSS/FOWLER, P.C. 2020  
PROJECT NUMBER: ..... 19017  
ISSUE DATE: ..... 09.03.2020

ENLARGED  
LANDSCAPE  
PLAN  
L302

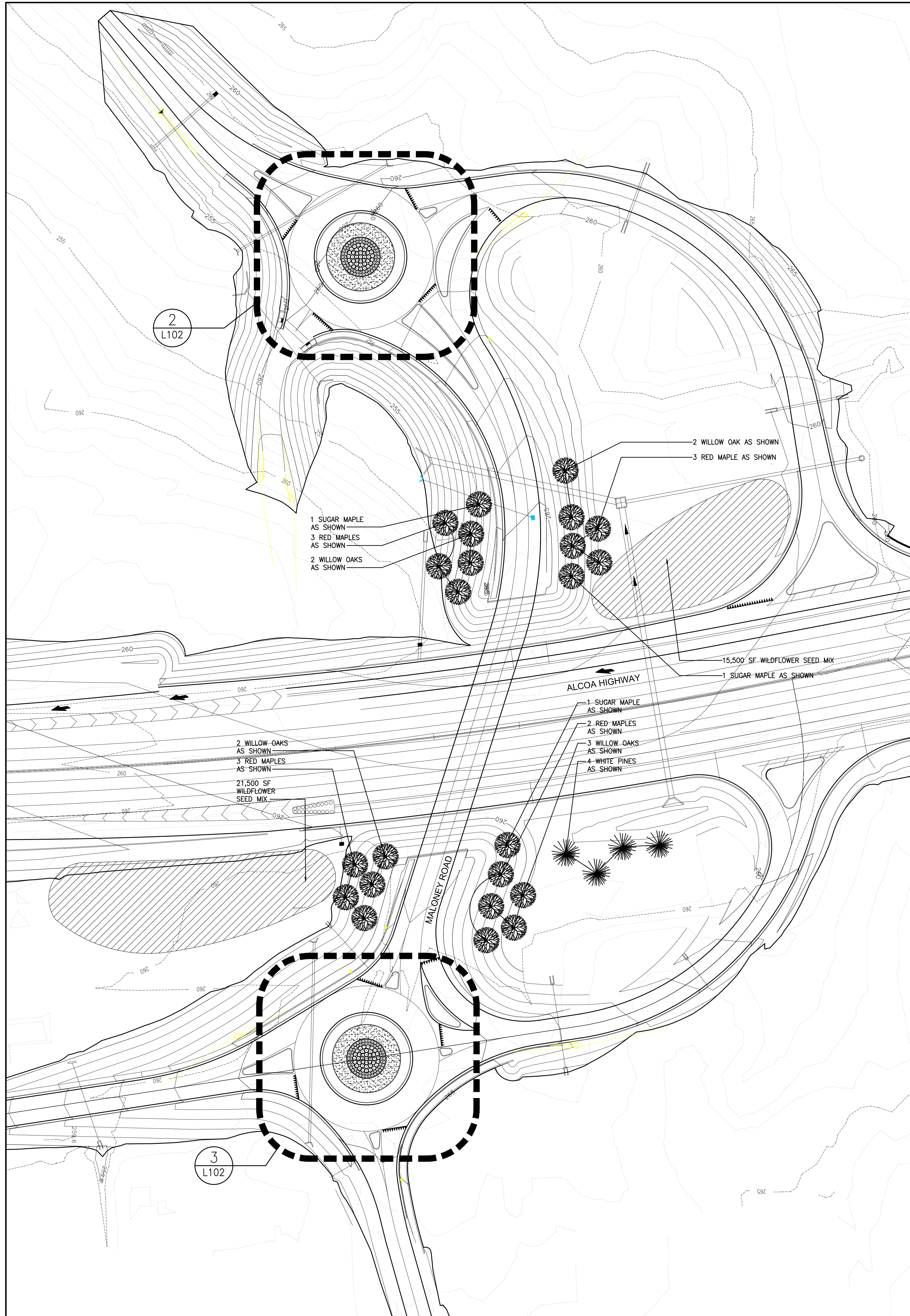

1 MALONEY ROAD  
L302 SCALE: 1"=50'

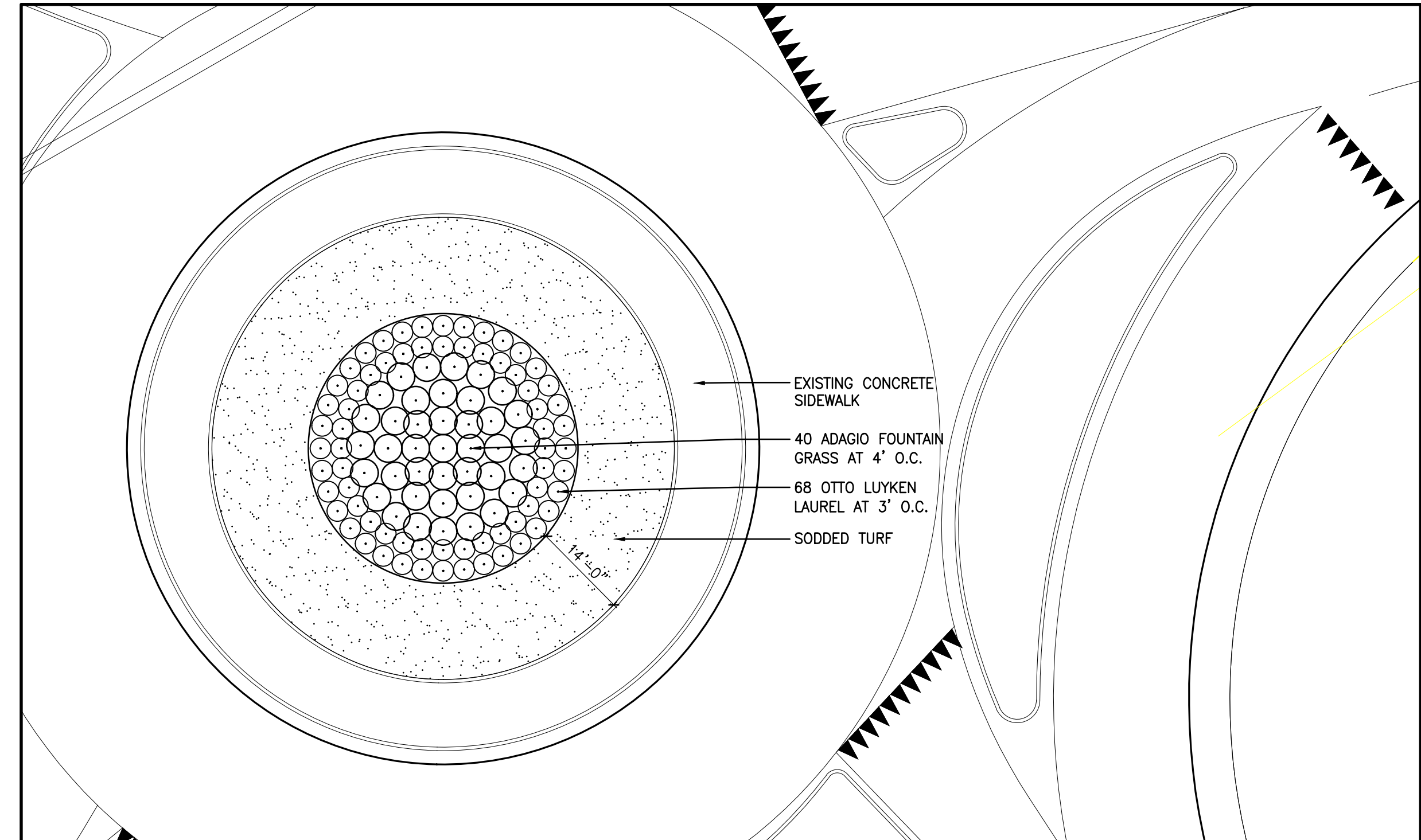
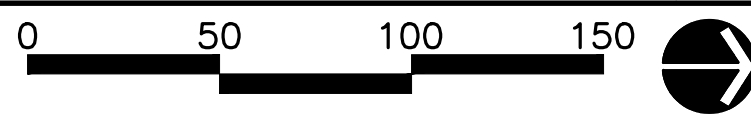

2 MALONEY ROAD WEST ROUNDABOUT  
L302 SCALE: 1/16"=1'-0"

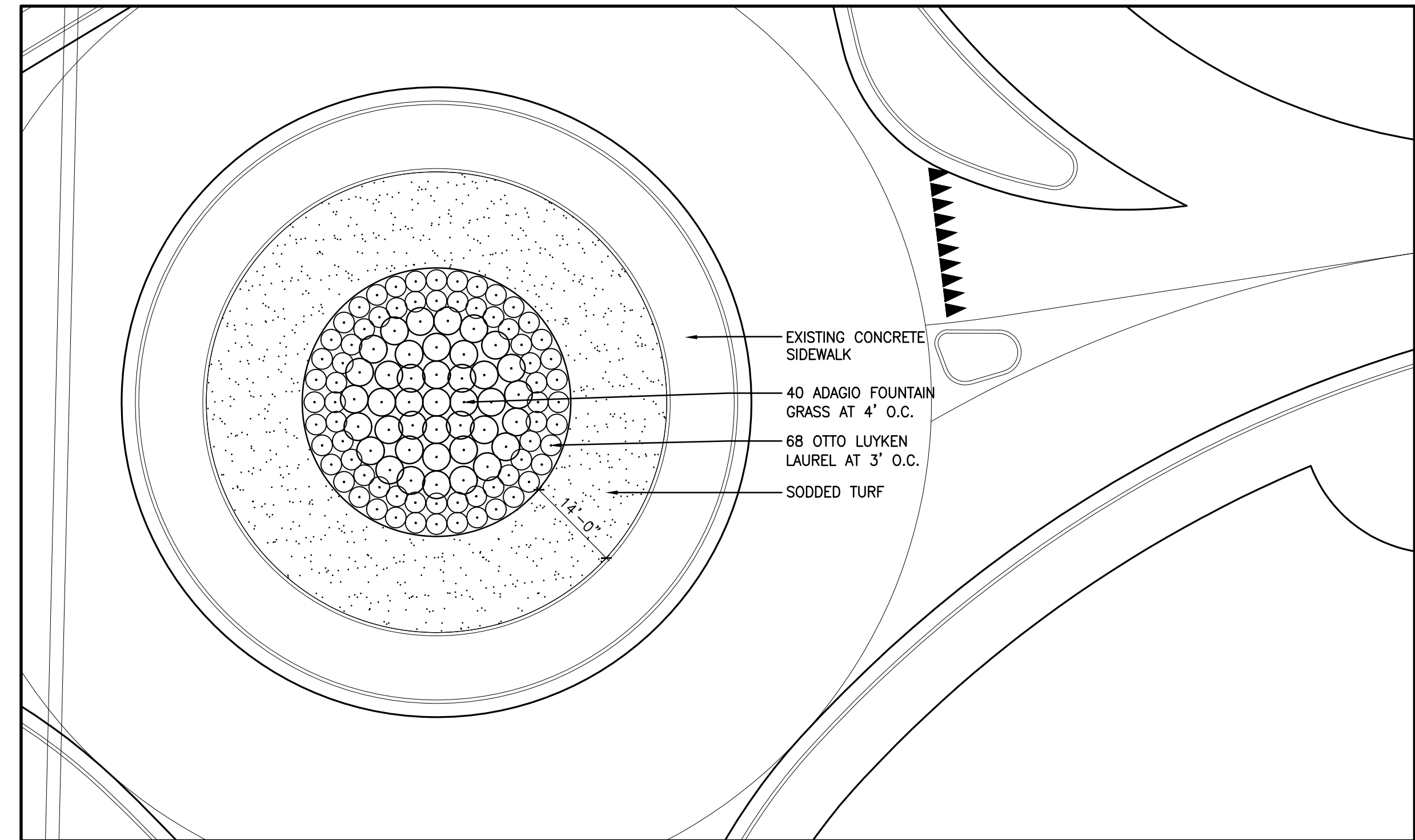
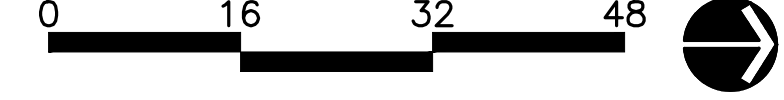

3 MALONEY ROAD EAST ROUNDABOUT  
L302 SCALE: 1/16"=1'-0"

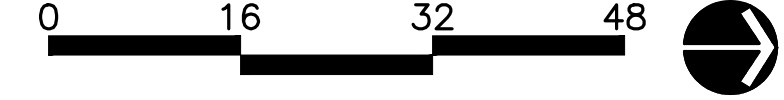

PLANT SCHEDULE - ALCOA HIGHWAY							
TYPE	KEY	BOTANICAL NAME	COMMON NAME	MIN. SIZE	ROOT	REMARKS	QUANTITY
TREES	ARD	ACER RUBRUM 'OCTOBER GLORY'	OCTOBER GLORY RED MAPLE	2" CAL.	B&B	CENTRAL LEADER, 4" CLEAR TRUNK	20
	ASL	ACER SACCHARUM 'LEGACY'	LEGACY SUGAR MAPLE	2" CAL.	B&B	CENTRAL LEADER, 4" CLEAR TRUNK	20
	CCA	CERCIS CANADENSIS	EASTERN REDBUD	2" CAL.	B&B	CENTRAL LEADER, 4" CLEAR TRUNK	16
	PST	PINUS STROBUS	EASTERN WHITE PINE	8" HGT.	B&B	CENTRAL LEADER, BRANCHED TO GROUND	25
	QSP	QUERCUS PHellos	WILLOW OAK	2" CAL.	B&B	CENTRAL LEADER, 4" CLEAR TRUNK	22
SHRUBS AND GRASSES	HPL	HYDRANGEA PANICULATA 'LIMELIGHT'	LIMELIGHT HYDRANGEA	30" HGT. X 30" WIDE	CONT.	FULL & DENSE	21
	ICO	ILEX CORNUTA 'CARISMA'	CARISMA HOLLY	24" HGT. X 24" WIDE	CONT.	FULL & DENSE	68
	MSA	MISCANTHUS SINENSIS 'ADAGIO'	ADAGIO FOUNTAIN GRASS	24" HGT. X 24" WIDE	CONT.	FULL & DENSE	80
	PLO	PRUNUS LAUROCESTRUS 'OTTO LUYKEN'	OTTO LUYKEN LAUREL	18" HGT. X 18" WIDE	CONT.	FULL & DENSE	136
WILDFLOWER MIX							
		CUSTOM WILDFLOWER SEED MIX BY APPLEWOOD SEED CO. OR APPROVED EQUAL			SEED		5 LB
		CENTAUREA CYANUS	RACHELOR'S BUTTON				
		CHRYSANTHEMUM LEUCANTHEMUM	OX-EYE Daisy				
		DELPHINIUM AJACIS	ROCKET LARKSPUR				
		ESCHSCHOLZIA CALIFORNICA	CALIFORNIA POPPY				
		PAPAYER RHODAS	RED CORN POPPY				

\*THE ABOVE PLANT SCHEDULE IS FOR REFERENCE ONLY. PLANT QUANTITIES ON THE PLANTING PLANS SHALL TAKE PRECEDENCE OVER QUANTITIES ON THE PLANT SCHEDULE.

PLANTING NOTES:

- THE LOCATION OF ALL SURFACE AND UNDERGROUND UTILITIES SHALL BE VERIFIED BY THE CONTRACTOR AT GROUND BREAK. THE CONTRACTOR SHALL BE RESPONSIBLE FOR PROTECTING ALL UTILITIES FROM DAMAGE AS REQUIRED DURING CONSTRUCTION AND TO REPAIR ANY DAMAGE WHICH SHOULD OCCUR TO THE SATISFACTION OF THE OWNER.
- AT START OF CONSTRUCTION OPERATIONS IDENTIFY AREAS OF GRASS TO BE KILLED. COMPLETELY ERADICATE ALL GRASS IN AREAS SHOWN TO BE WITHIN A MULCHED BED.
- PROTECT EXISTING GRASS AREAS TO REMAIN. SEED ALL AREAS WITHIN AND ADJOINING PROJECT LIMITS DISTURBED AS A RESULT OF CONSTRUCTION OPERATIONS WHICH ARE NOT OTHERWISE SHOWN TO BE PLANTED.
- ALL PLANTS SHALL BE APPROVED BY LANDSCAPE ARCHITECT PRIOR TO INSTALLATION.
- THE LOCATION OF ALL TREES SHALL BE APPROVED BY THE LANDSCAPE ARCHITECT BEFORE THE DIGGING OF PITS. PLANTING SHALL BE LOCATED WHERE SHOWN ON THE DRAWINGS OR WHERE FIELD LOCATED BY LANDSCAPE ARCHITECT.
- ESTABLISH SMOOTH CURVILINEAR MOWING/BED LINES WHERE LAWN MEETS MULCHED SHRUB OR GROUND COVER MASS. BED LINE LOCATIONS SHALL BE APPROVED BY LANDSCAPE ARCHITECT BEFORE BEGINNING BED PREPARATION.
- PROVIDE APPROVED TOPSOIL TO PERFORM INCIDENTAL GRADING WORK.
- HALF TONE IMAGES ARE EXISTING CONDITIONS INCLUDED FOR REFERENCE. PROTECT FROM DAMAGE.
- SEE SHEET L201 FOR NOTES REGARDING TOPSOIL SPECIFICATIONS AND PLACEMENT.
- WILDFLOWER SEEDS SHALL BE CAREFULLY AND UNIFORMLY MIXED PRIOR TO PLANTING.
- PERFORM SEEDING OPERATIONS WHEN THE SOIL IS DRY AND WHEN WINDS DO NOT EXCEED 5 MILES PER HOUR VELOCITY.
- NO INDIVIDUAL SEEDED AREAS SHALL HAVE BARE SPOTS OR UNACCEPTABLE COVER TOTALING MORE THAN 2% OF THE INDIVIDUAL AREAS.
- MULCH ALL AREAS OF TREE, SHRUB AND GROUND COVER MASS PLANTING WITH 2" OF SHREDDED HARDWOOD BARK MULCH.
- MULCH ALL AREAS OF WILDFLOWER PLANTING WITH A LIGHT COVERING HAY OR STRAW TO PREVENT EROSION AND CONSERVE MOISTURE TO AID GERMINATION. AVOID LEAVING CLUMPS OF HAY ON THE BEDS AS THEY WILL IMPEDE WILDFLOWER SEED GERMINATION.
- PLANS ARE BASED ON TDO DRAWINGS DATED BETWEEN 1/9/2016 AND 5/15/2017. CONTRACTOR TO VERIFY EXISTING CONDITIONS BEFORE PROCEEDING AND REPORT ANY DISCREPANCIES TO THE LANDSCAPE ARCHITECT.